

TYPICAL CROSS SECTIONS B-13

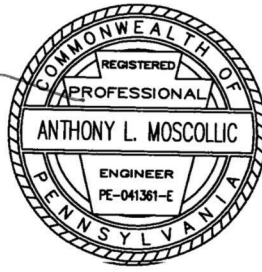

DISCLAIMER NOTICE:
 SPECIFIC INFORMATION
 REQUIRED FOR COMPLIANCE
 WITH LOCAL CODES IS THE
 RESPONSIBILITY OF THE
 DESIGNER

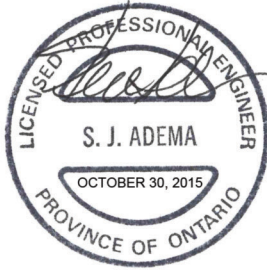
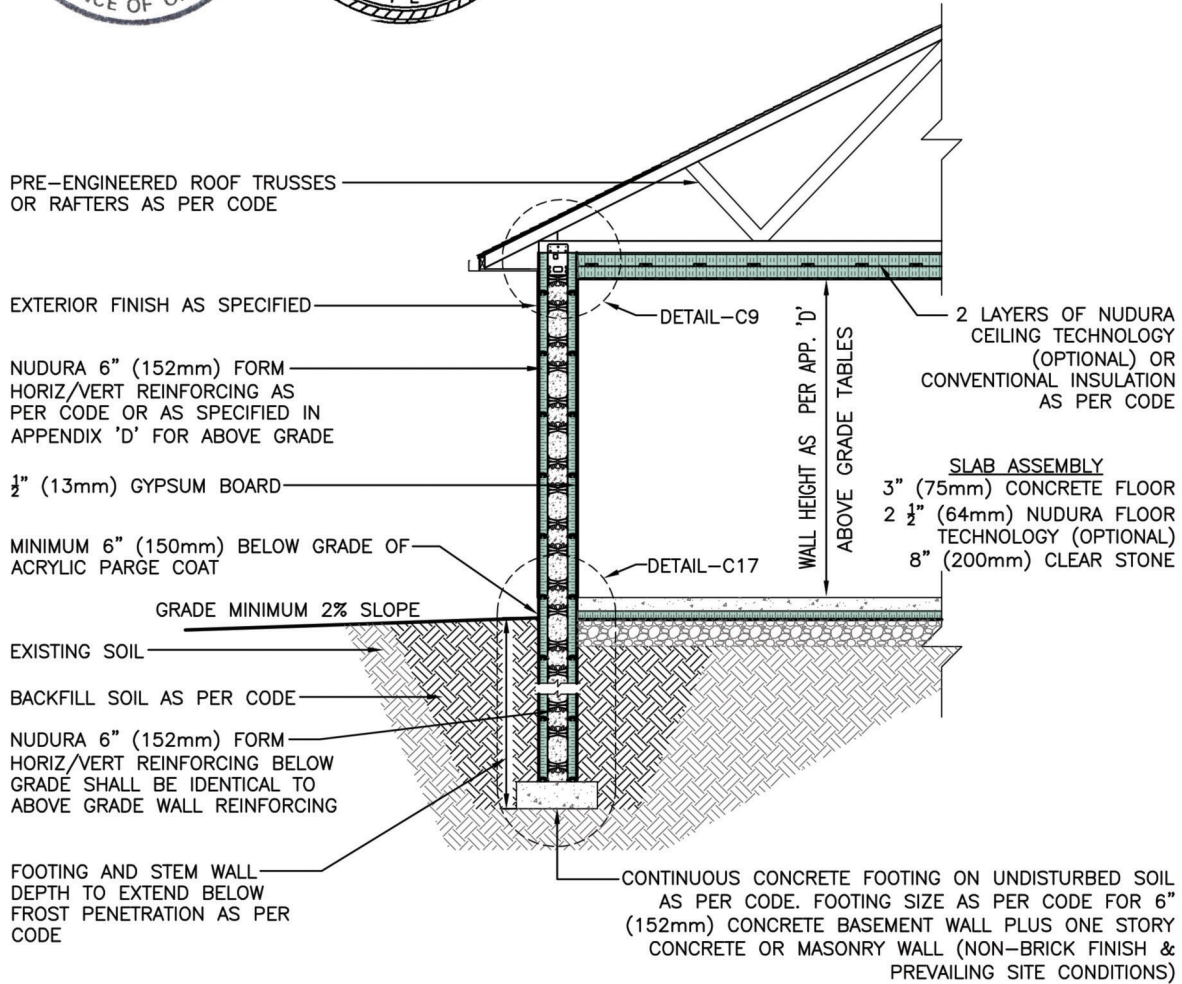

*NOTE: IN ADDITION TO FOOTING SIZE INDICATED BY CODE, ADD 1" (25.4mm) WIDTH TO STRIP FOOTING FOR EVERY 1'-0" (305mm) OF CONCRETE WALL HEIGHT ABOVE 8'-0" (2440mm) PER STORY



BUILDING SECTION
 6" (152mm) FORM FROST WALL
 SLAB ON GRADE
 1 STORY 6" (152mm) FORM UNIT
 NON-BRICK FINISH

REV. NO. 002 KS	DWG NO. B-13
REV. DATE: SEPT 2015	
DATE: K. STILL	SCALE: "Not to Scale"